

**ILVE S.p.a.**

UHP95FC/I

UHP95FC

05/06/2015

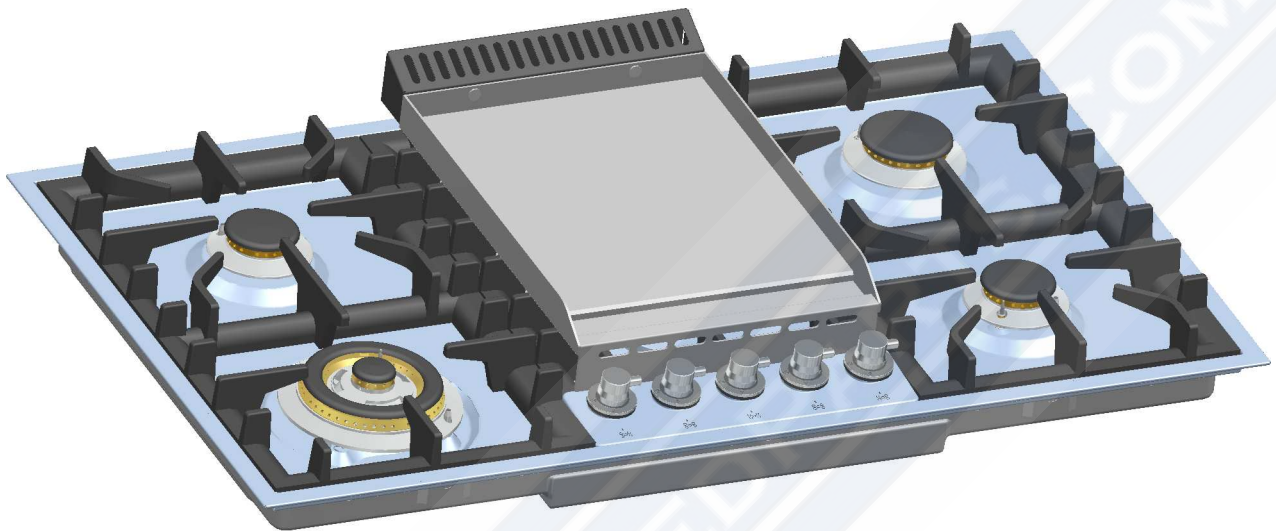

**i ILVE**  
*the art of cooking*

UHP95FC

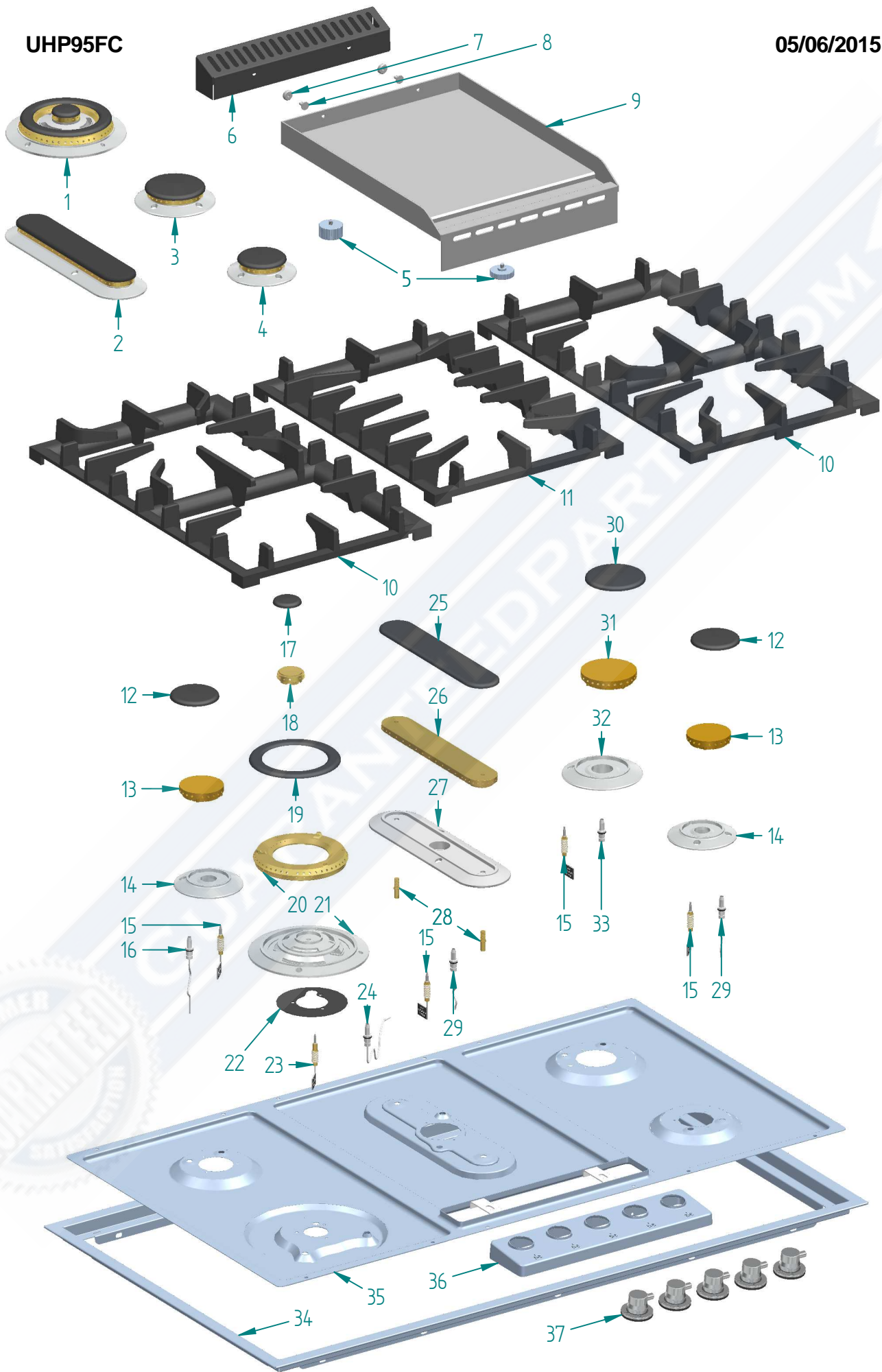

| <i>dis.</i> | <i>cod.</i> | <i>descrizione</i>                              | <i>description</i>                               |
|-------------|-------------|---|--|
| 1           | KBR014      | KIT BRUC TRIPLA COR SPART C/PIOLI               | COMPLETE TR RING BURNER                          |
| 2           | KBR002      | KIT BRUC PESCIERA 2 FORI                        | COMPLETE FISH BURNER (2 HOLES)                   |
| 3           | KBR003      | KIT BRUC RAP PIANO/CUC PROF 2 FORI              | COMPLETE RAPID BURNER (2 HOLES)                  |
| 4           | KBR004      | KIT BRUC SEM RAP PIA/CUC PRO 2 FORI             | COMPLETE SMALL RAPID BURN (2 HOLES)              |
| 5           | G/450/00    | SPESSORE (KIT) FRY TOP HP95                     | SCREWS FOR HP95 FRY TOP                          |
| 6           | S/008/30/14 | CAMINETTO FRY TOP H90 NERO MAT                  | FRY TOP CHIMNEY H90                              |
| 7           | A/082/32    | GHIERA FIL M5 FISS CAMINO FRY TOP H90           | RING   |
| 8           | A/602/28    | VITE FISS CERN COP S40/FRY TOP H90 ZINC DIS.043 | SPECIAL SCREW                                    |
| 9           | A/419/04    | PIASTRA FRY TOP H30-H90-HP95                    | FRY TOP PLATE FOR H90P                           |
| 10          | A/092/01/10 | GRIGLIA PROFESS HP95-HP65SX VETR                | GRID FOR P95-P65SX HOB                           |
| 11          | A/092/06/10 | GRIGLIA PROFESS PESCIERA HP95 VETR              | FISH BURNER GRID FOR P95                         |
| 12          | A/048/06/10 | COPRISPART PICCOLO (S1) RAF MAT 3F              | SMALL FLAME DIFFUSER COVER                       |
| 13          | A/478/12/92 | SPARTIFIAMMA PICCOLO                            | NEW SMALL FLAME DIFFUSER                         |
| 14          | A/488/11/93 | TAZZINA P C PICCOLA (2 FORI)                    | HOB COOKER SMALL CUP+IGN+S.V. HOLES              |
| 15          | A/490/03    | TERMOCOPPIA BIFIL 45CM M8X1                     | THERMOCOUPLE 45                                  |
| 16          | A/018/06    | CANDELA ACC.(CAVO=MM800 H=MM28)                 | IGNITION PLUG MM 800                             |
| 17          | A/048/07/10 | COPRISPART TC AUX RAF MAT 3F                    | TRIPLE RING BURNER SMALL COVER                   |
| 18          | A/478/17    | SPARTIFIAMMA TC AUSILIARIO +INDEX               | TR RING SMALL FLAME DIVIDER (INDEX)              |
| 19          | A/048/09/10 | COPRISPART TC GR 1V/DUAL RAF MAT 3F             | TRIPLE RING FLAME DIVIDER COVER                  |
| 20          | A/478/21    | SPARTIFIAMMA TC GRANDE 1 V/DUAL +P              | DUAL TRIPLE RING BIG FLAME DIVIDER WITH SUPPORTS |
| 21          | A/488/23    | TAZZINA TC (2 FORI)                             | TRIPLER RING CUP+IGN+S.V. HOLES                  |
| 22          | S/091/26    | DISCO PROTEZIONE TC HP95                        | ENAMELED RING                                    |
| 23          | A/490/20    | TERMOCOPPIA BIFIL TC 95CM M8X1                  | THERMOCOUPLE 45                                  |
| 24          | A/018/00    | CANDELA ACC.(CAVO=MM1200 H=MM28)                | IGNITION PLUG MM 1200                            |
| 25          | A/048/04/10 | COPRISPART PESCIERA RAF MAT 3F                  | FISH BURNER FLAME DIFFUSER COVER                 |
| 26          | A/478/08    | SPARTIFIAMMA PESCIERA                           | FISH BURNER BRASS FLAME DIFFUSER                 |
| 27          | A/488/13    | TAZZINA PESCIERA (2 FORI)                       | FISH BURNER CUP+IGN+S.V. HOLES                   |
| 28          | A/602/42    | VITE PESCIERA 8X26XM6 OTTONE                    | RETAINING SCREW FOR FISH BURNER                  |
| 29          | A/018/04    | CANDELA ACC.(CAVO=MM600 H=MM28)                 | IGNITION PLUG MM 600                             |
| 30          | A/048/02/10 | COPRISPART GRANDE (S2) RAF MAT 3F               | LARGE FLAME DIFFUSER COVER                       |
| 31          | A/478/12/90 | SPARTIFIAMMA GRANDE                             | NEW LARGE FLAME DIFFUSER                         |
| 32          | A/488/11/91 | TAZZINA P C GRANDE (2 FORI)                     | HOB COOKER LARGE CUP+IGN+S.V. HOLES              |
| 33          | A/018/02    | CANDELA ACC.(CAVO=MM400 H=MM28)                 | IGNITION PLUG MM 400                             |
| 34          | S/049/00/08 | CORNICE PIANO HP95 INOX                         | CORNICE FOR P95 / ST.ST.                         |
| 35          | S/174/94/08 | PIANO UHP95PC INOX                              | COOK TOP UHP95PC / ST.ST.                        |
| 36          | S/063/22/08 | CRUSCOTTINO INCL HP95PC SER DU INOX             | CONTROL PANEL FOR HP95PC / ST.ST.                |
| 37          | G/348/06/08 | MANOPOLA GAS HP95 NERO INOX ML                  | GAS KNOB FOR HP95 / SH ST ST                     |

%{Titolo



UHP95FC

05/06/2015

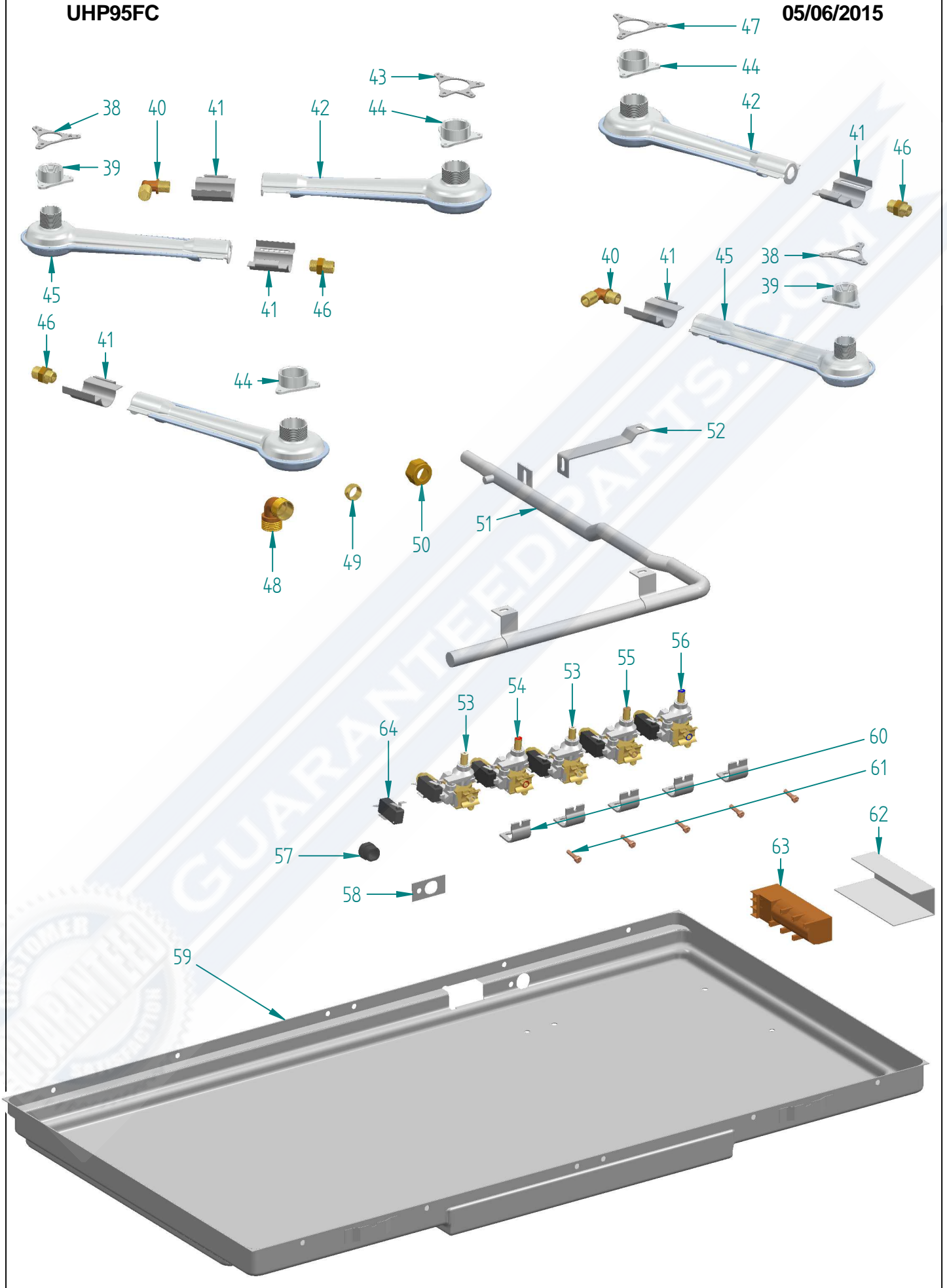



| <i>dis.</i> | <i>cod.</i> | <i>descrizione</i>                                      | <i>description</i>                                     |
|-------------|-------------|---|--|
| 38          | S/001/01    | ADATTATORE GHIERA PICCOLA PIANI USA                     | BURNER ADAPTOR   |
| 39          | A/082/31    | GHIERA AL 22X12 (PICCOLA)                               | SMALL BURNER RING                                      |
| 40          | A/434/04    | PORTAINIETT A GOMITO GRILL/FUOCHI                       | INJECTOR HOLDER GRILL/COOKTOP                          |
| 41          | S/096/00    | FARFALLA REG ARIA BRUC SOGLIOLA                         | BURNER AIR REG. BUTTERFLY VALVE                        |
| 42          | A/014/21    | BRUCIATORE SOGLIOLA GRANDE ALLUMINATO                   | BIG BURNER   |
| 43          | S/001/02    | ADATTATORE GHIERA PESCIERA PIANI USA                    | BURNER ADAPTOR   |
| 44          | A/082/30    | GHIERA AL 28X12 (GRANDE)                                | BIG BURNER RING  |
| 45          | A/014/20    | BRUCIATORE SOGLIOLA PICCOLO ALLUMINATO                  | SMALL BURNER   |
| 46          | A/434/05    | PORTAINIETT PIANI OT DRITTO DIS.346                     | INJECTOR HOLDER  |
| 47          | S/001/00    | ADATTATORE GHIERA GRANDE PIANI USA                      | BURNER ADAPTOR   |
| 48          | A/452/04    | RACC CURVO PORTAG (SIRAL) 1/2" PO-04 D.14 OT 9360000070 | HOSETAIL COUPLING (SIRAL)                              |
| 49          | A/004/04    | BICONO 14MM RACCORDO PORTAGOMMA S135 944000016          | HOSE NUT   |
| 50          | A/062/20    | DADO 1/2 D.14 RACCORDO PORTAGOMMA A/415/11 935002022    | NUT HOSETAIL S.436/4                                   |
| 51          | A/454/05    | RAMPA PIANO HP95 SABAF                                  | RAMP FOR P95   |
| 52          | S/118/03    | FERMARAMPA HP95/HP65 LAT POST                           | RAMP FRONT STOP FOR HP95                               |
| 53          | A/466/62    | RUB CON MICRO PIANI VALV (45)SR USA                     | VALVE + S.V.   |
| 54          | A/466/54    | RUB CON MICRO PIANI VALV (50)P                          | VALVE + S.V.   |
| 55          | A/466/63    | RUB CON MICRO PIANI VALV (55) R USA                     | VALVE + S.V.   |
| 56          | A/466/55    | RUB CON MICRO PIANI VALV (61)TC                         | VALVE + S.V.   |
| 57          | A/008/02    | BLOCCACAVO PICCOLO PIANI 6N3-4                          | PLASTIC STRIP /COOKTOP                                 |
| 58          | S/190/04    | PIASTRINA BLOCCACAVO PIANI                              | COOKTOP CABLE CLAMPING PLAQUE                          |
| 59          | S/010/55    | CASSETTA PIANO COTT HP95-HP95C                          | BED HP95-HP95C   |
| 60          | A/012/06    | BRIGLIA RUB PIANI RAMPA TONDA D=16                      | SABAF VALVE CLAMP                                      |
| 61          | A/600/38    | VITE BR RAMPA TONDA RUB SABAF                           | SCREW  |
| 62          | A/024/12    | CARTONCINO ISOL NOMEX TRASF 6FUOCHI                     | NOMEX INSULATING CARD FOR IGNITION TRANSFORMER 6 BURNE |
| 63          | A/494/27    | TRASFORMATORE ACC EL 6 FUOCHI UL                        | 6 WAYS IGN TRANSFORMER                                 |
| 64          | A/401/12    | MICROINT ACC RUB SABAF PIANI VALV                       | IGNITION SWITCH  |

%{Titolo}

GUARANTEE

RTS.COM

