



**CAUTION!**

PLEASE KEEP POWER SWITCH ON  
BEFORE OPERATING THE UNIT

**GLASS DOOR REFRIGERATOR**

**Installation and Operation Manual**



**ATTENTION!**

GARDEZ EN BOUTON ALLUME  
AVANT D'OPERER L'UNITE

*Please read this manual completely before attempting to install or operate this equipment!*



**IMPORTANT SAFETY INSTRUCTIONS**

R5109-162

5659 Royalmount Ave.  
Montreal, QC H4P2P9 CANADA  
Telephone: (514) 737-9701  
Toll Free Telephone: 1-888-275-4538  
Fax: (514) 342-3854

3560 NW 56th St.  
Fort Lauderdale, FL 33309 USA  
Telephone: (786) 600-4687  
Toll Free Telephone: 1-844-218-8477  
Fax: (786) 661-4100  
Email: [service@mvpgroupcorp.com](mailto:service@mvpgroupcorp.com)

For service call 1-888-275-4538

## CONTENTS

1. SPECIFICATIONS .....	2
2. SERIAL NUMBER .....	2
3. INSTALLATION .....	3
4. CLEANING .....	4
5. CAUTION .....	4
6. BASIC OPERATION .....	5 - 6
7. TROUBLE SHOOTING GUIDE .....	9

## SPECIFICATIONS

### Glass Door Refrigerators

MODEL	COMP. H.P	REFRIGERANT	AMPS	WEIGHT
KBSR-1G	1/4	R-290	2.0A	271LBS
KBSR-2G	1/2	R-290	5.6A	370LBS

## SERIAL NUMBER

The serial number is located on the rating label which is on the left interior wall.  
Please retain the unit's serial number for service purposes.

# INSTALLATION

## 1. GOOD AIR CIRCULATION

- Be sure to avoid any object which will restrict exhausted air flow.
- Be sure that there is ample space so that air can flow through the rear of the unit.
- The back of the unit should be located no less than 5 inches from the wall.

## 2. PLACE ON STRONG GROUND

- Be sure the location chosen has a floor strong enough to support the total weight of the cabinet and contents.

## 3. DO NOT PLACE NEAR HEAT SOURCE

- Be sure to avoid hot corner or location near stove, oven, or other heat source.
- High ambient temperature will make cooling efficiency lower.

## 4. INDOOR USAGE ONLY

- This equipment is intended for indoor use only.

## 5. STABILIZING

- Make sure the unit is installed in a stable condition with the front wheels locked while in use.

## 6. LEVELING

- Be sure that the unit is level from front to back and side to side.

## 7. Unit should be on dedicated electrical circuit.

- Do not use extension cords
- Isolate the unit on an electrical circuit of proper size.

## 8. Place black plastic condensate pan thru back or front.

Make sure pads are installed upwards and drain hose is in pan.

## 9. Install the unit where the air circulation is good.

- Maintain enough spaces around the unit since air circulation is very important for the unit cooling performance.
- If air circulation is obstructed, then cooling performance will drop, consuming more electricity as a result.

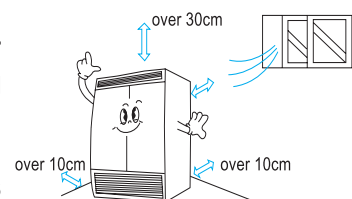

## CLEANING

### 1. CLEANING THE INTERIOR AND EXTERIOR

- The interior and exterior of the unit can be cleaned using warm water with soap.
- Do not use an abrasive cleaner because it will scratch the surface.

### 2. CLEANING THE CONDENSER FINS

- To maintain proper refrigeration performance, the Condenser coil must be free of dust, dirt, and grease.

It will require to clean it periodically. Condenser fins should be cleaned, at least every three months (90 days) or as needed.

### 3. CLEAN THE GASKET

- The door gasket should be cleaned frequently to maintain proper sealing. Use warm water and a mild soap.

### 4. CHECK AFTER CLEANING

- Check the unit again for safety.
- Check that the unit is operating properly.

## CAUTION

### 1. POWER CORD

- Be sure the power cord is connected to the proper voltage.
- Compressor warranties are void if compressor burns out due to improper voltage.
- A protected circuit of the correct voltage and amperage must be run for connection of the line cord.
- Turn ' off ' the power switch before disconnecting the power cord whenever performing maintenance functions or cleaning the refrigerated cabinet.
- If the power cord of Refrigerator (Freezer) is damaged, it must be replaced by the manufacturer or service agent or a similarly qualified person in order to avoid a hazard.

### 2. RE-STARTING

- If disconnected, wait 5 minutes before re-starting.

## ENERGY STAR

This Energy star labeled product may save you money on your energy costs.



**ENERGY STAR**

ENERGY STAR® OPTION AVAILABLE ENERGY STAR qualified models feature highly efficient compressors, generously sized condensers and evaporators and EC evaporator motors. These models may also qualify for energy rebate programs.

An ENERGY STAR® product uses energy more efficiently, saves you money on utility bills and helps protect the environment. Please refer to the ENERGY STAR® related information in [www.energystar.gov](http://www.energystar.gov) for more details.

## BASIC OPERATION

KBSR-1G, KBSR-2G

### REFRIGERATOR

1. Plug in and turn on the power switch located on the bottom of the top grill. The Display panel will be lighted. The compressor will begin to run.
2. The default temperature setting is 35°F (+2°C)
3. The compressor is automatically cycled by the electronic controller (PCB).
4. Temp. Control range 28°F ~ 39°F (-3°C ~ 7°C)
5. The interior light is activated by the door switch when the door is opened.
6. Evaporator fan motor(s) will run after all doors are completely closed.

## DISPLAY PANEL

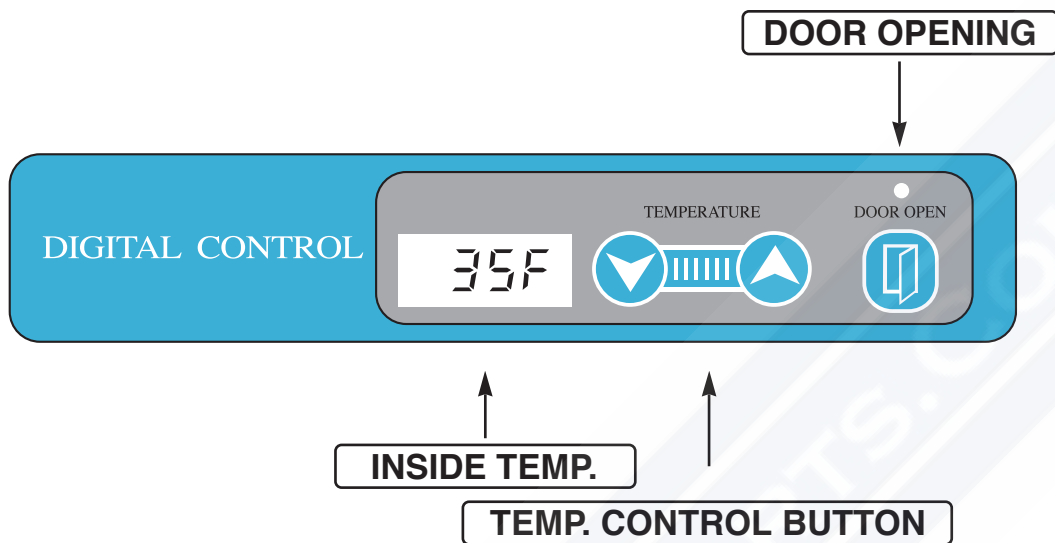

### 1. UP / DOWN BUTTON (Temperature control button)

- By pushing the up/down button, you can set the inside temperature.

### 2. DOOR OPENING INDICATOR

- If door is opened, door opening indicator will be turned on.
- If the door is left open for 3 minutes an alarm will sound continuously.
- The alarm will stop immediately upon closing the door.

## TROUBLE SHOOTING GUIDE

SYMPTOMS	CAUSES	SOLUTIONS
Refrigerator/Freezer is freezing (thawing) food.	<ul style="list-style-type: none"> <li>● The Temp. is set too low (high) to maintain food freshness.</li> </ul>	<ul style="list-style-type: none"> <li>● Push the button to a warmer (colder) position.</li> </ul>
The unit does not refrigerate at all.	<ul style="list-style-type: none"> <li>● There is a power connection failure problem.</li> </ul>	<ul style="list-style-type: none"> <li>● Check the power cord to make sure the unit is plugged in correctly.</li> </ul>
The unit does not refrigerate well.	<ul style="list-style-type: none"> <li>● The unit is in sunlight or near a heating device.</li> <li>● The unit contains hot food or too much food.</li> <li>● The unit door is opened too frequently or left open too long.</li> <li>● The temp. Is not set on the correct position.</li> <li>● The condenser is clogged.</li> </ul>	<ul style="list-style-type: none"> <li>● Check the installation place.</li> <li>● Check the condition of stored food.</li> <li>● Check the position of the temperature setted.</li> <li>● Clean condenser.</li> </ul>
There is a loud noise.	<ul style="list-style-type: none"> <li>● The floor is too weak or the unit is not level.</li> <li>● The back-side of the unit is too close to the wall.</li> <li>● The tray is not in the correct position.</li> </ul>	<ul style="list-style-type: none"> <li>● Check the installation and adjust the tray position.</li> </ul>
There is condensation in the unit exterior.	<ul style="list-style-type: none"> <li>● High-moisture air can produce dew-drops during high condensation humidity.</li> </ul>	<ul style="list-style-type: none"> <li>● Wipe with a dry cloth.</li> </ul>
There is condensation the unit interior.	<ul style="list-style-type: none"> <li>● The door is opened too frequently or left open too long.</li> <li>● Damp food is stored.</li> </ul>	<ul style="list-style-type: none"> <li>● Keep the door closed to remove condensation.</li> </ul>
The door does not close tightly.	<ul style="list-style-type: none"> <li>● The door is bent.</li> <li>● The door gasket has come out.</li> <li>● The unit is not level.</li> </ul>	<ul style="list-style-type: none"> <li>● Reposition the gasket.</li> <li>● Level the unit again.</li> </ul>

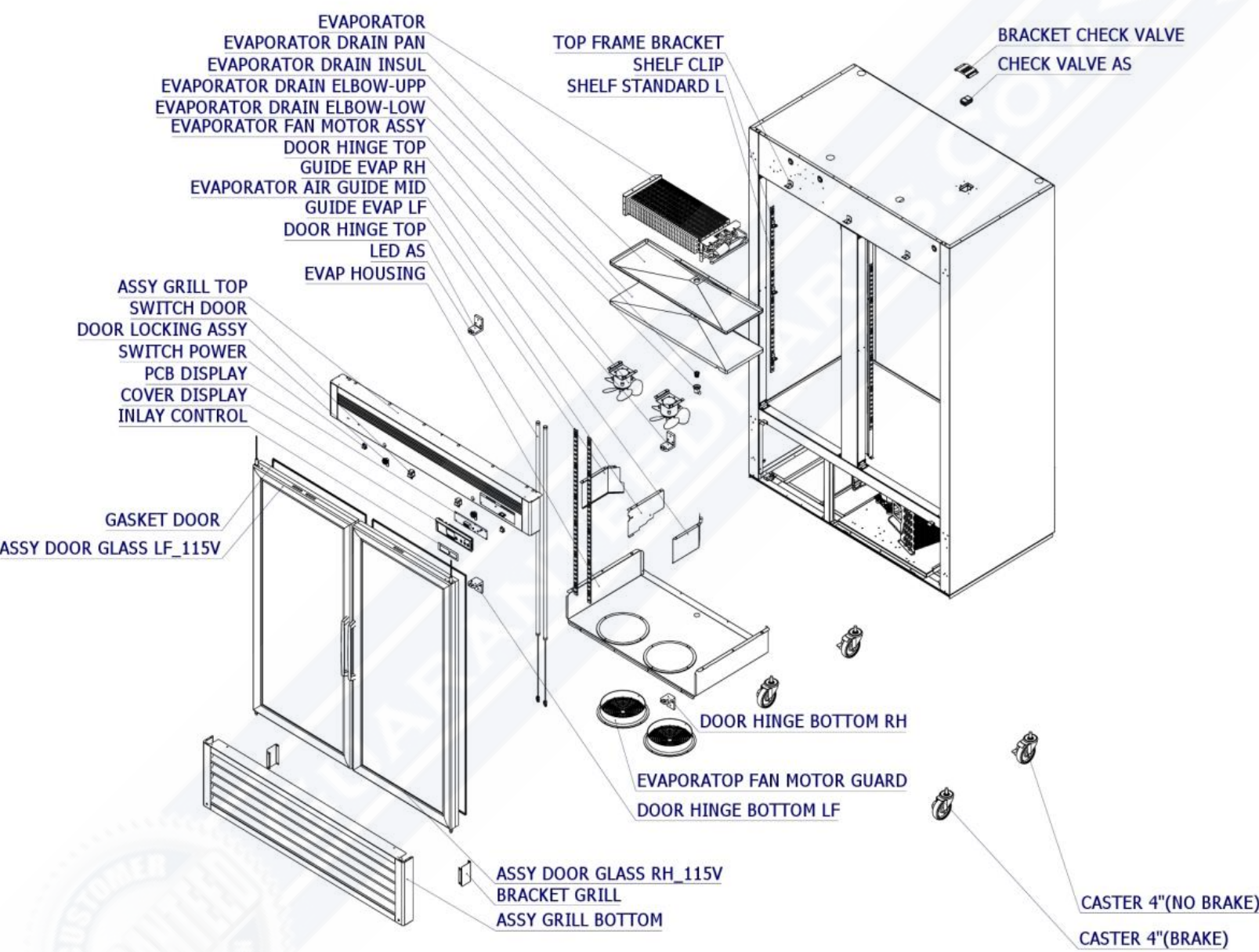

**KBSR-2G**